



Sliding Over Fixed Rooflight Series

- Wide range of sizes available
- Concealed electromechanical drive
- Can open to any position
- Polyester powder-coated aluminium framework
- Can be controlled by phone app
- Thermally efficient
- Secured with multiple locking points
- Provides approximately 50% clear opening
- Up to 8000mm (external Width) in the sliding direction
- Up to 4000mm (external Span) down the fall
- Up to a 45° pitch
- Unlocks rooftop space by providing access to terrace

- Optional
- Access key pad
 - Rain sensor
 - Light curtain (Anti-trap)
 - Temperature sensor



Fully Open Position



Closed Position



GENERAL NOTES

1. NO DIMENSIONS ARE TO BE SCALED FROM THIS DRAWING.
2. DISCREPANCIES IN SITE DIMENSIONS TO BE REPORTED TO NEXT GENERATION ROOFLIGHTS.
3. ALL DIMENSIONS IN MILLIMETERS.
4. ALL LEVELS IN METRES.
5. THIS DRAWING REMAINS THE PROPERTY OF VISION AGI LIMITED AND MAY NOT BE COPIED, REPRODUCED OR ITS CONTENTS DIVULGED WITHOUT PRIOR WRITTEN CONSENT FROM VISION AGI LIMITED.

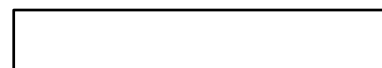

Next Generation Rooflights is a trading name of Vision AGI Limited, Company No. 08429446, Registered Office: 1 Vicarage Lane, Stratford, London, E15 4HF

Rev	Date	Init	Revision

NEXT GENERATION ROOFLIGHTS
 Queens Business Park
 Wilbraham Road
 Fulbourn
 Cambridge
 CB21 5GT
 T: 01223 792 224
 E: sales@nextgenrooflights.co.uk
 info@nextgenrooflights.co.uk
 W: nextgenrooflights.co.uk



Client: _____

Title: Sliding Over Fixed - Rooflight 3D Images & Characteristics			
Project: Rooflight			
Scales: NTS	Date: 01/07/22	Drawn: CR	Chk: CR
Drg No.: 300-SALES-101(0)		Rev: -	

Section B-B (Scale 1 : 25)

(Closed Position)

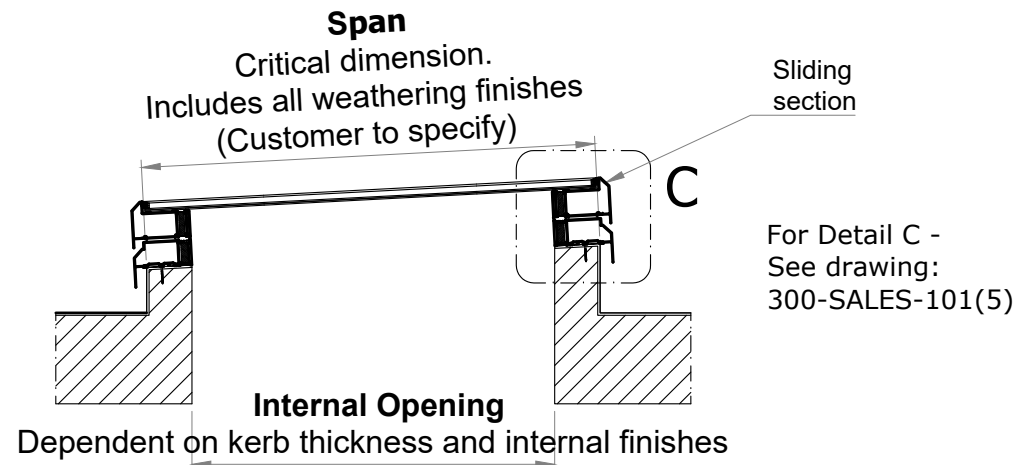

Plan View (Scale 1:50)

(Closed Position)

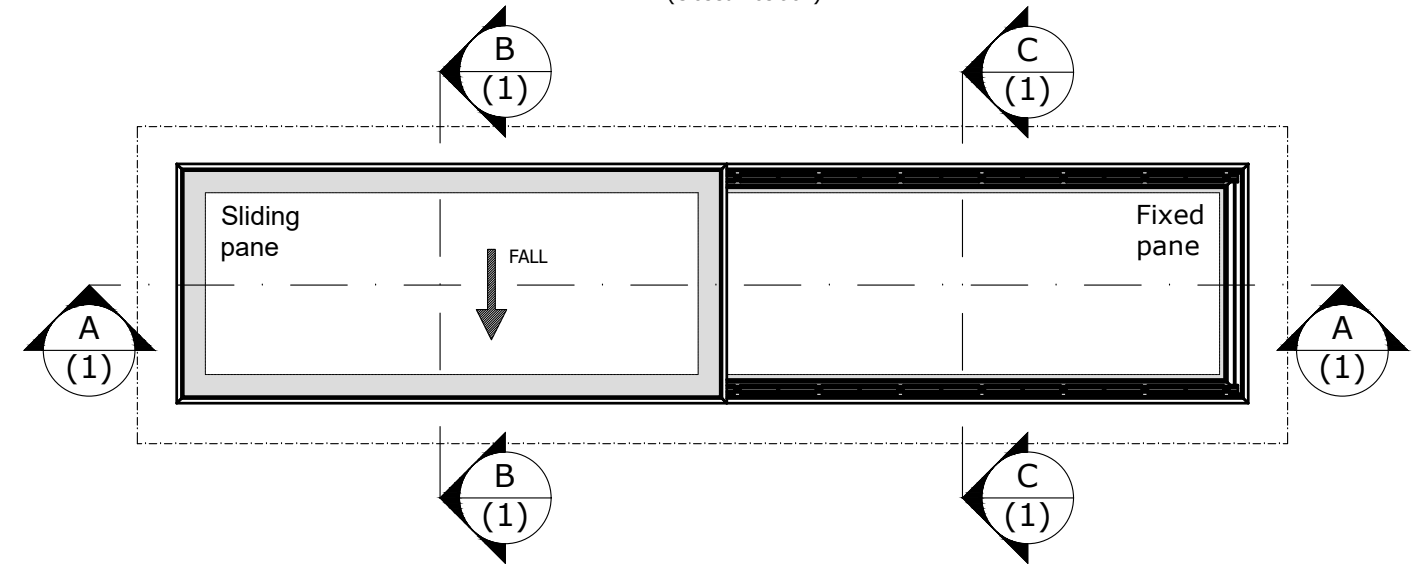

Section C-C (Scale 1 : 25)

(Closed Position)

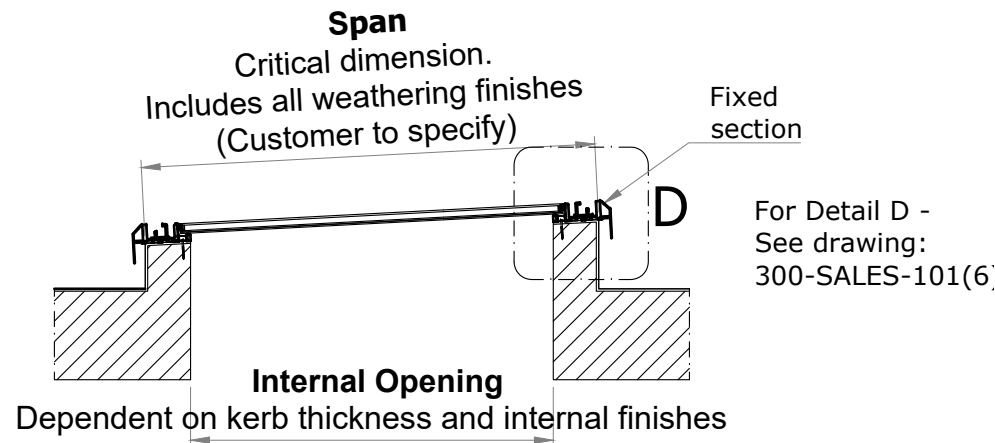

GLASS CONFORMS TO IMPACT RESISTANCE AND BREAKAGE CHARACTERISTICS OF BS EN 12600:2002. IGUs FABRICATED TO BS EN 1279 AND SUPPLIED IN ACCORDANCE WITH BS 5516-2:2004.
 FINISH SPECIFICATION:
 POLYESTER POWDER COATED; MIN 40 MICRONS
 STANDARD EXTERNAL COLOUR: **RAL 7015 Slate Grey**
 STANDARD INTERNAL COLOUR: **RAL 9010 Pure White**
 FIXING SPECIFICATION: **A2 STAINLESS STEEL**
 SEALANTS SPECIFICATION: **NEUTRAL CURE TO BS5889**
 ALL DIMENSIONS mm UNLESS OTHERWISE STATED.

Section A-A (Scale 1 : 25)

(Closed Position)

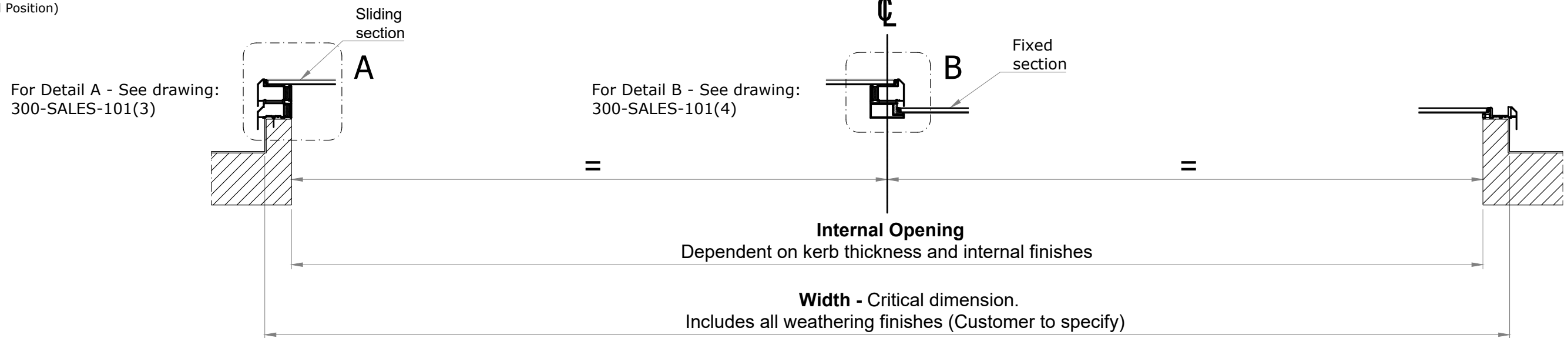

GENERAL NOTES

- NO DIMENSIONS ARE TO BE SCALED FROM THIS DRAWING.
- DISCREPANCIES IN SITE DIMENSIONS TO BE REPORTED TO NEXT GENERATION ROOFLIGHTS.
- ALL DIMENSIONS IN MILLIMETERS.
- ALL LEVELS IN METRES.
- THIS DRAWING REMAINS THE PROPERTY OF VISION AGI LIMITED AND MAY NOT BE COPIED, REPRODUCED OR ITS CONTENTS DIVULGED WITHOUT PRIOR WRITTEN CONSENT FROM VISION AGI LIMITED.

Next Generation Rooflights is a trading name of Vision AGI Limited, Company No. 08429446, Registered Office: 1 Vicarage Lane, Stratford, London, E15 4HF

Rev	Date	Init	Revision

NEXT GENERATION ROOFLIGHTS
 Queens Business Park
 Wilbraham Road
 Fulbourn
 Cambridge
 CB21 5GT
 T: 01223 792 224
 E: sales@nextgenrooflights.co.uk
 info@nextgenrooflights.co.uk
 W: nextgenrooflights.co.uk

Client:

Title: Sliding Over Fixed - Rooflight Closed Position			
Project: Rooflight			
Scales: 1:25 & 1:50 @ A3	Date: 01/07/22	Drawn: CR	Chk: CR
Drg No.: 300-SALES-101(1)		Rev: -	

Section E-E (Scale 1 : 25)

(Fully Open Position)

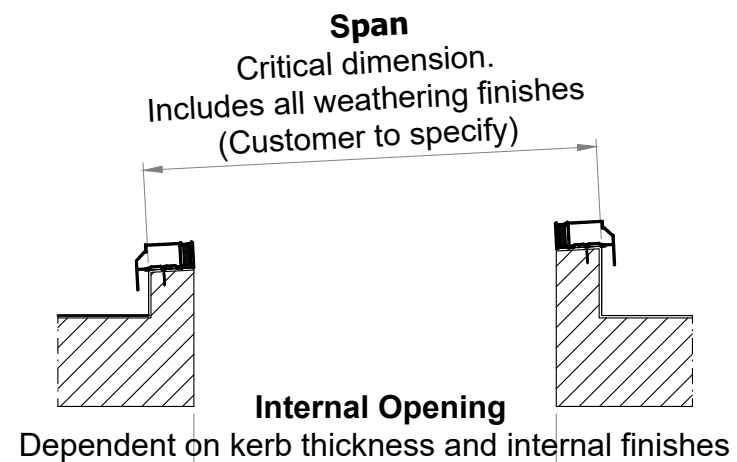

Section F-F (Scale 1 : 25)

(Fully Open Position)

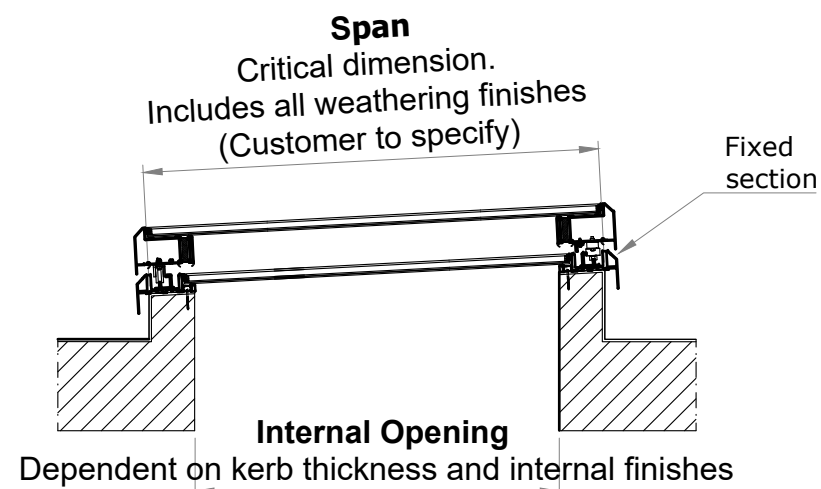

Section D-D (Scale 1 : 25)

(Fully Open Position)

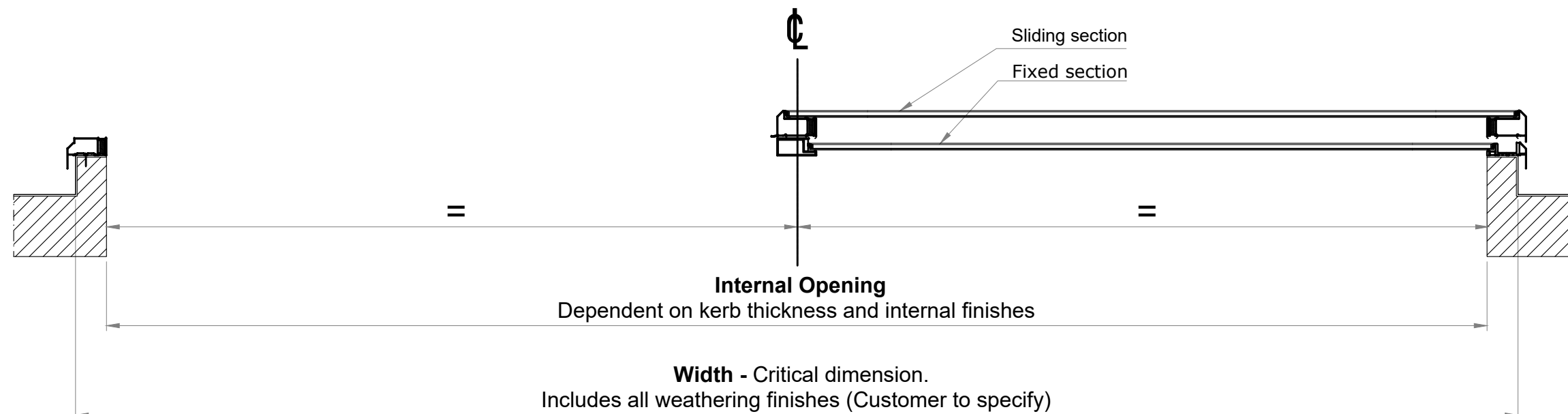

Plan View (Scale 1:50)

(Fully Open Position)

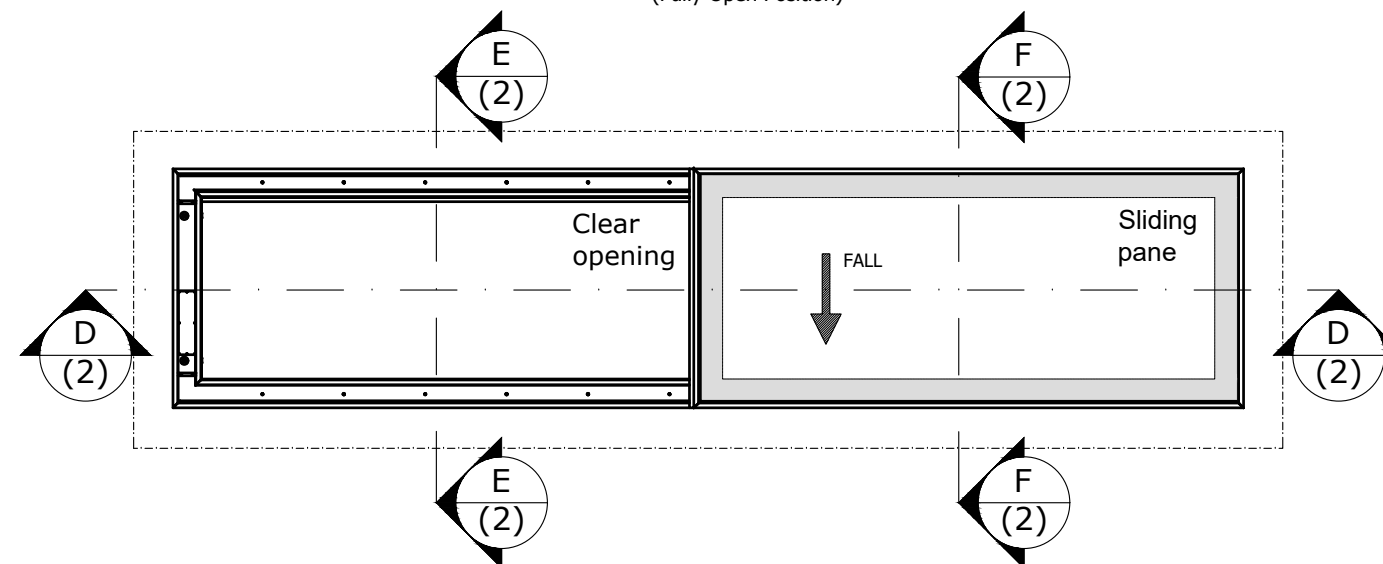

GLASS CONFORMS TO IMPACT RESISTANCE AND BREAKAGE CHARACTERISTICS OF BS EN 12600:2002. IGUs FABRICATED TO BS EN 1279 AND SUPPLIED IN ACCORDANCE WITH BS 5516-2:2004.

FINISH SPECIFICATION:
POLYESTER POWDER COATED; MIN 40 MICRONS
STANDARD EXTERNAL COLOUR: **RAL 7015 Slate Grey**
STANDARD INTERNAL COLOUR: **RAL 9010 Pure White**
FIXING SPECIFICATION: **A2 STAINLESS STEEL**
SEALANTS SPECIFICATION: **NEUTRAL CURE TO BS5889**
ALL DIMENSIONS mm UNLESS OTHERWISE STATED.



GENERAL NOTES

1. NO DIMENSIONS ARE TO BE SCALED FROM THIS DRAWING.
2. DISCREPANCIES IN SITE DIMENSIONS TO BE REPORTED TO NEXT GENERATION ROOFLIGHTS.
3. ALL DIMENSIONS IN MILLIMETERS.
4. ALL LEVELS IN METRES.
5. THIS DRAWING REMAINS THE PROPERTY OF VISION AGI LIMITED AND MAY NOT BE COPIED, REPRODUCED OR ITS CONTENTS DIVULGED WITHOUT PRIOR WRITTEN CONSENT FROM VISION AGI LIMITED.

Next Generation Rooflights is a trading name of Vision AGI Limited, Company No. 08429446, Registered Office: 1 Vicarage Lane, Stratford, London, E15 4HF

Rev	Date	Init	Revision

NEXT GENERATION ROOFLIGHTS
Queens Business Park
Wilbraham Road
Fulbourn
Cambridge
CB21 5GT
T: 01223 792 224
E: sales@nextgenrooflights.co.uk
info@nextgenrooflights.co.uk
W: nextgenrooflights.co.uk



Client:

Title: Sliding Over Fixed - Rooflight
Fully Open Position

Project: Rooflight		Date:	Drawn:	Chk:
Scale:	1:25 & 1:50 @ A3	01/07/22	CR	CR
Drg No.:	300-SALES-101(2)		Rev:	-

Detail A (Scale 1:2)

(Closed Position)

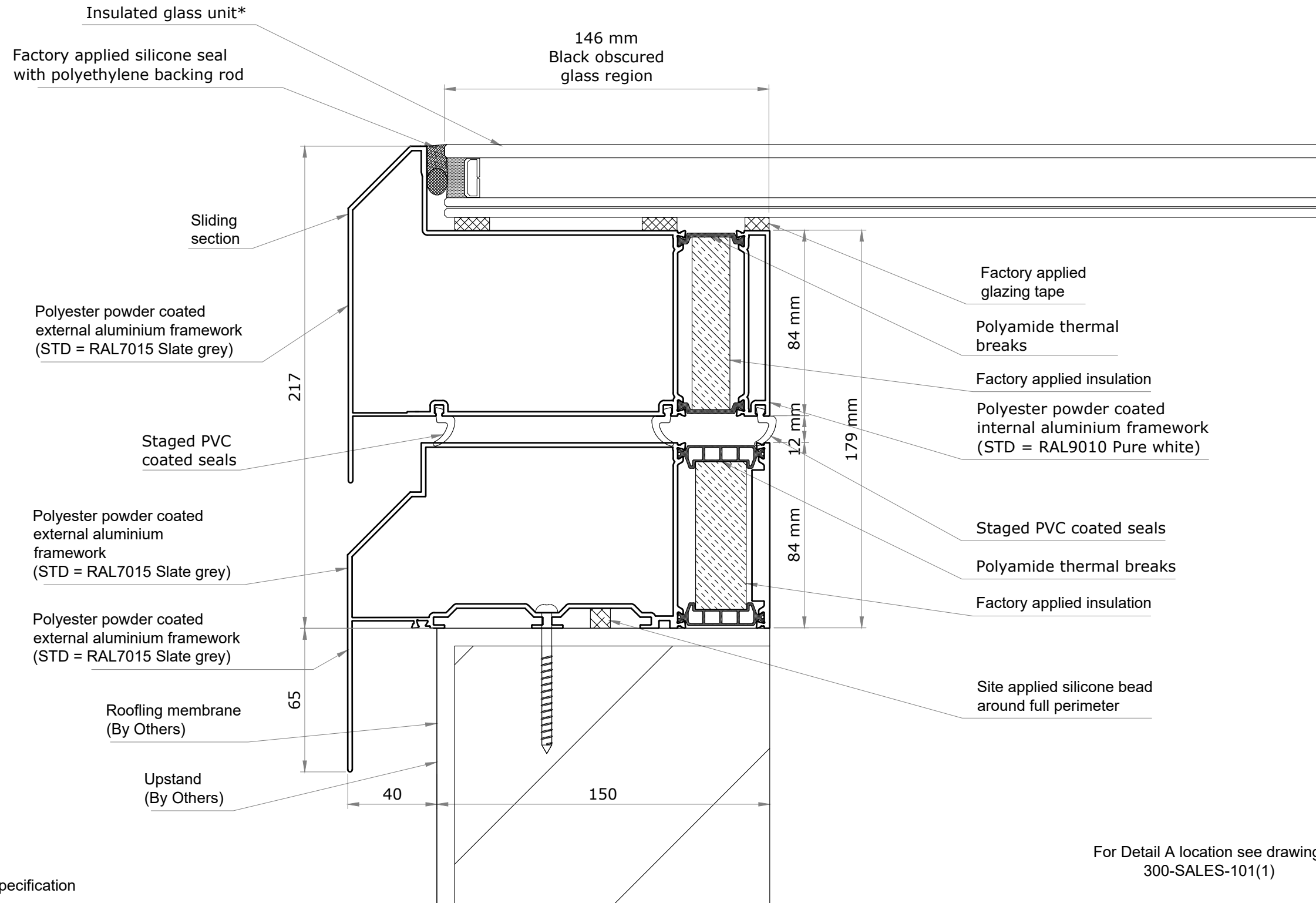

*Varies - dependent on glass specification

For Detail A location see drawing:
300-SALES-101(1)

GENERAL NOTES	
1. NO DIMENSIONS ARE TO BE SCALED FROM THIS DRAWING.	
2. DISCREPANCIES IN SITE DIMENSIONS TO BE REPORTED TO NEXT GENERATION ROOFLIGHTS.	
3. ALL DIMENSIONS IN MILLIMETERS.	
4. ALL LEVELS IN METRES.	
5. THIS DRAWING REMAINS THE PROPERTY OF VISION AGI LIMITED AND MAY NOT BE COPIED, REPRODUCED OR ITS CONTENTS DIVULGED WITHOUT PRIOR WRITTEN CONSENT FROM VISION AGI LIMITED.	

Rev	Date	Init	Revision
		JWL	

NEXT GENERATION ROOFLIGHTS
 Queens Business Park
 Wilbraham Road
 Fulbourn
 Cambridge
 CB21 5GT
 T: 01223 792 224
 E: sales@nextgenrooflights.co.uk
 info@nextgenrooflights.co.uk
 W: nextgenrooflights.co.uk



Client:

Title: Sliding Over Fixed - Rooflight Detail A			
Project: Rooflight			
Scales: 1:2 @ A3	Date: 01/07/22	Drawn: CR	Chk: CR
Drg No.: 300-SALES-101(3)		Rev: -	

Detail B (Scale 1:2)

(Closed Position)

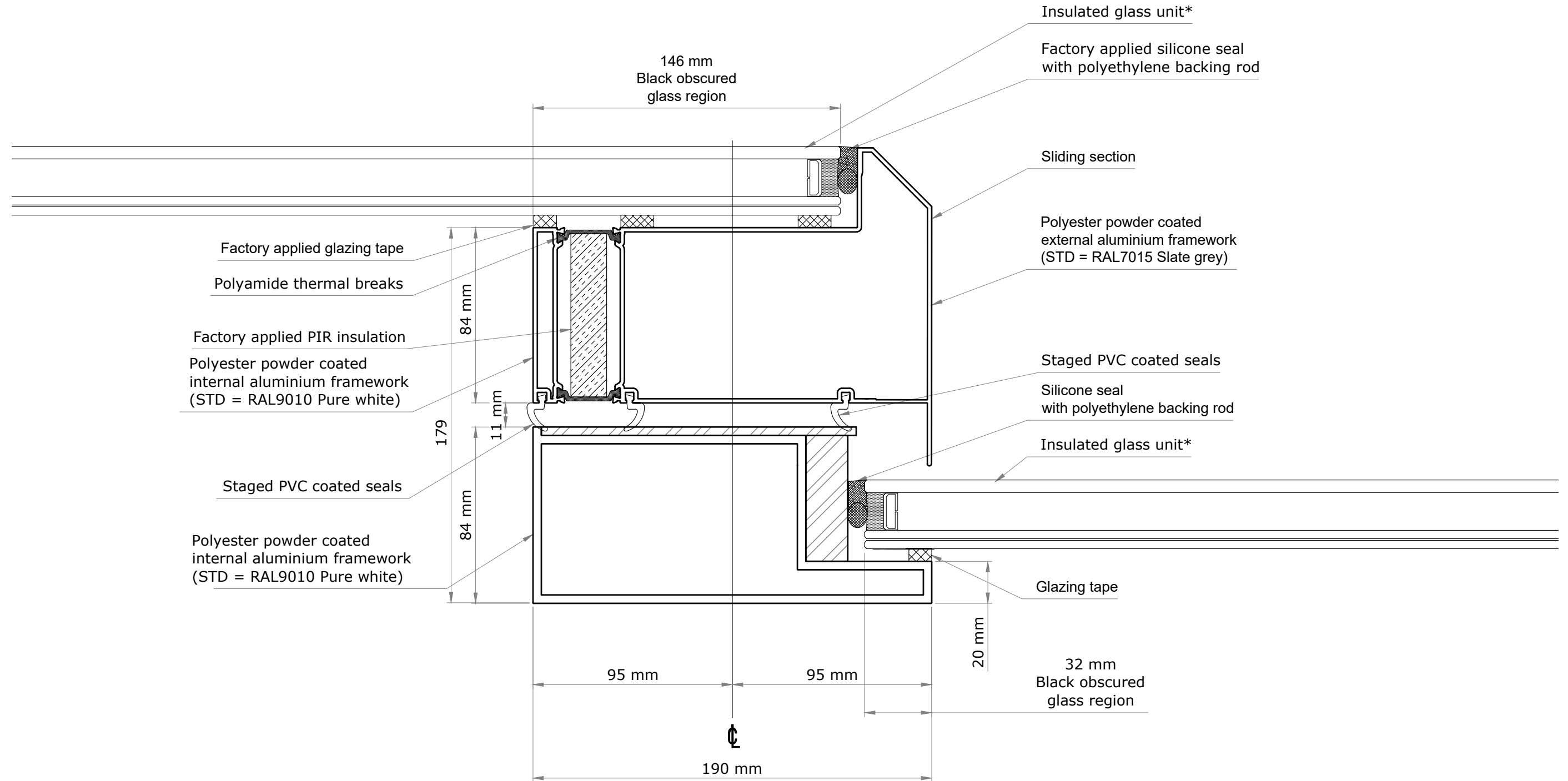

*Varies - dependent on glass specification

For Detail B location see drawing:
300-SALES-101(1)



GENERAL NOTES

1. NO DIMENSIONS ARE TO BE SCALED FROM THIS DRAWING.
2. DISCREPANCIES IN SITE DIMENSIONS TO BE REPORTED TO NEXT GENERATION ROOFLIGHTS.
3. ALL DIMENSIONS IN MILLIMETERS.
4. ALL LEVELS IN METRES.
5. THIS DRAWING REMAINS THE PROPERTY OF VISION AGI LIMITED AND MAY NOT BE COPIED, REPRODUCED OR ITS CONTENTS DIVULGED WITHOUT PRIOR WRITTEN CONSENT FROM VISION AGI LIMITED.

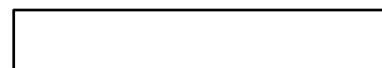

Next Generation Rooflights is a trading name of Vision AGI Limited, Company No. 08429446, Registered Office: 1 Vicarage Lane, Stratford, London, E15 4HF

Rev	Date	Init	Revision

NEXT GENERATION ROOFLIGHTS
 Queens Business Park
 Wilbraham Road
 Fulbourn
 Cambridge
 CB21 5GT
 T: 01223 792 224
 E: sales@nextgenrooflights.co.uk
 info@nextgenrooflights.co.uk
 W: nextgenrooflights.co.uk



Client: _____

Title: Sliding Over Fixed - Rooflight Detail B			
Project: Rooflight			
Scales: 1:2 @ A3	Date: 01/07/22	Drawn: CR	Chk: CR
Drg No.: 300-SALES-101(4)		Rev: -	

Detail C (Scale 1:2)
(Closed Position)

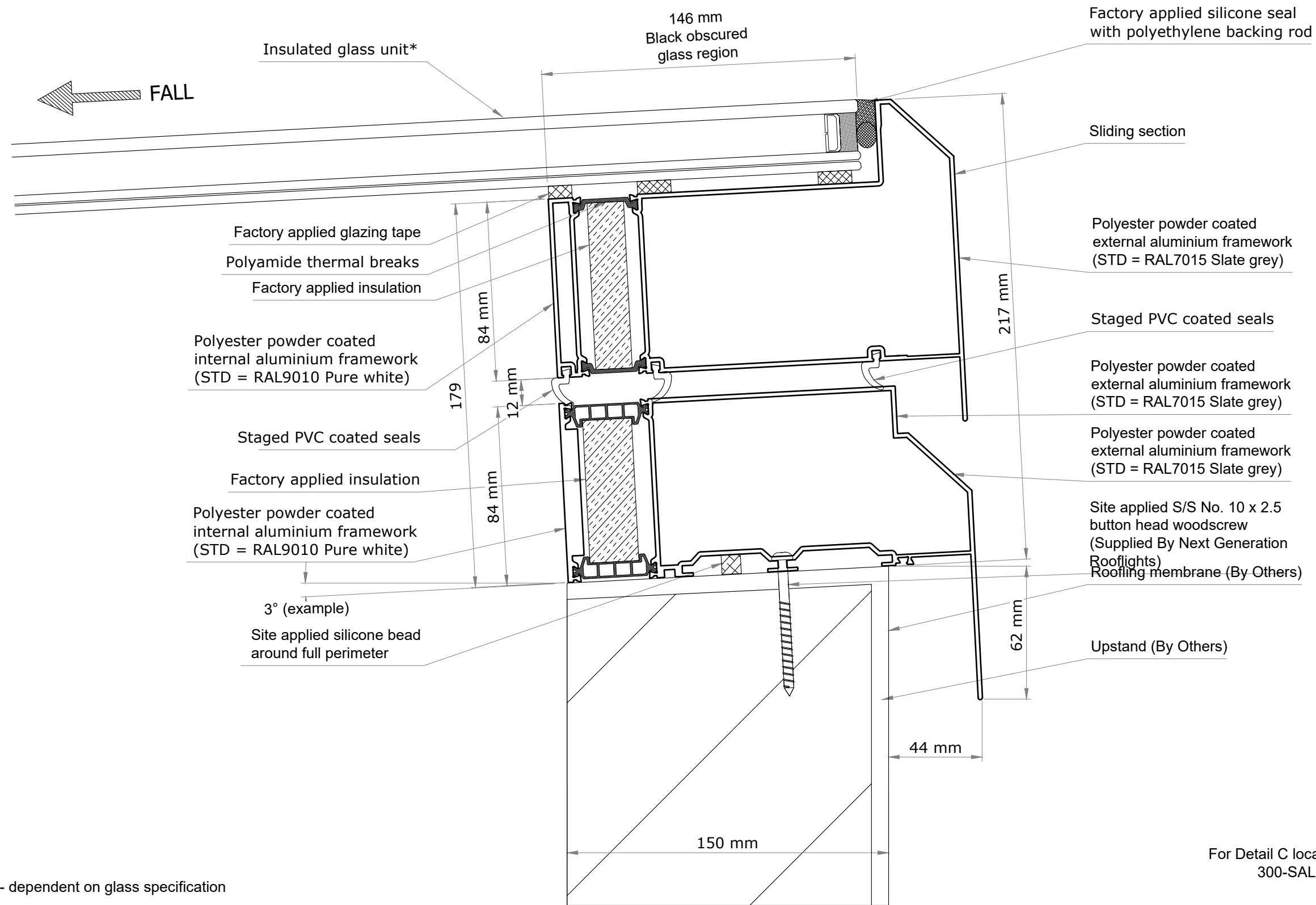

*Varies - dependent on glass specification

For Detail C location see drawing:
300-SALES-101(1)

GENERAL NOTES	
1. NO DIMENSIONS ARE TO BE SCALED FROM THIS DRAWING.	
2. DISCREPANCIES IN SITE DIMENSIONS TO BE REPORTED TO NEXT GENERATION ROOFLIGHTS.	
3. ALL DIMENSIONS IN MILLIMETERS.	
4. ALL LEVELS IN METRES.	
5. THIS DRAWING REMAINS THE PROPERTY OF VISION AGI LIMITED AND MAY NOT BE COPIED, REPRODUCED OR ITS CONTENTS DIVULGED WITHOUT PRIOR WRITTEN CONSENT FROM VISION AGI LIMITED.	

Rev	Date	Init	Revision

NEXT GENERATION ROOFLIGHTS
Queens Business Park
Wilbraham Road
Fulbourn
Cambridge
CB21 5GT
T: 01223 792 224
E: sales@nextgenrooflights.co.uk
info@nextgenrooflights.co.uk
W: nextgenrooflights.co.uk



Client:

Title: Sliding Over Fixed - Rooflight Detail C			
Project: Rooflight			
Scales: 1:2 @ A3	Date: 01/07/22	Drawn: CR	Chk: CR
Drg No.: 300-SALES-101(5)		Rev: -	

Detail D (Scale 1:2)
(Closed Position)

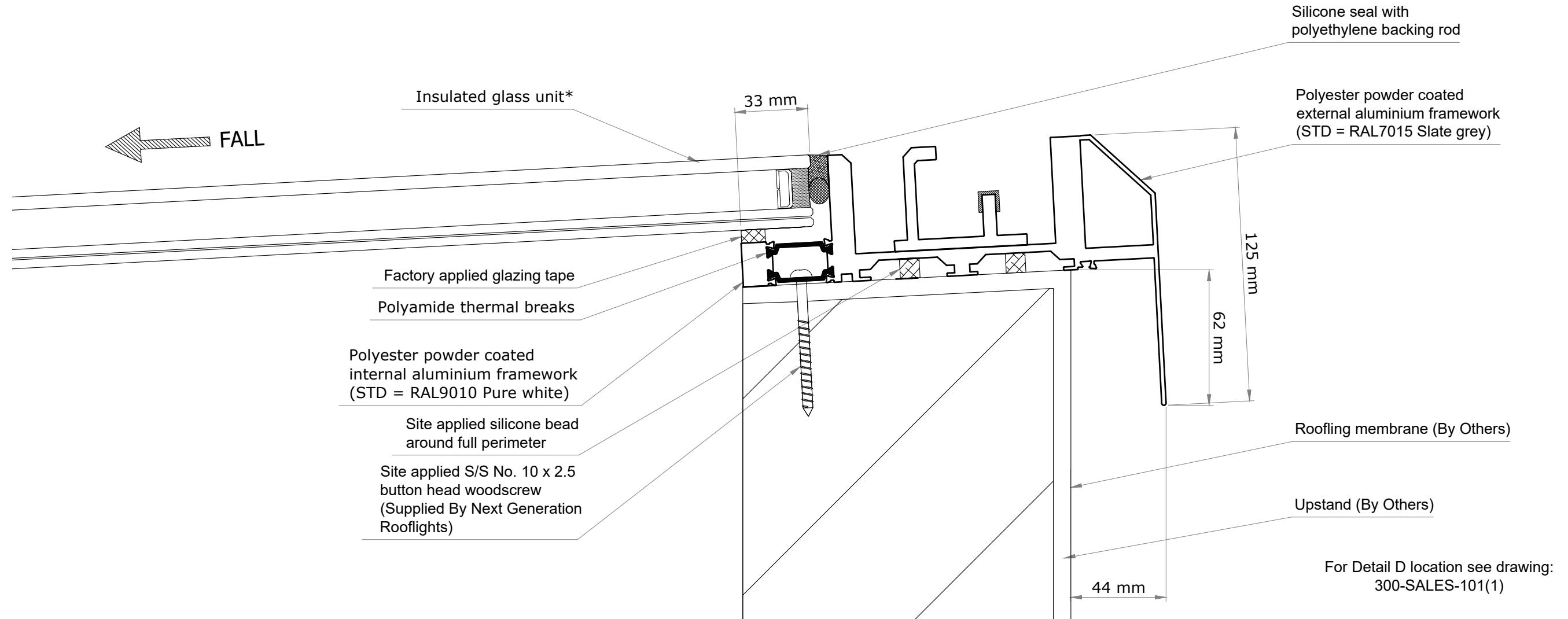

*Varies - dependent on glass specification

GENERAL NOTES	
1. NO DIMENSIONS ARE TO BE SCALED FROM THIS DRAWING.	
2. DISCREPANCIES IN SITE DIMENSIONS TO BE REPORTED TO NEXT GENERATION ROOFLIGHTS.	
3. ALL DIMENSIONS IN MILLIMETERS.	
4. ALL LEVELS IN METRES.	
5. THIS DRAWING REMAINS THE PROPERTY OF VISION AGI LIMITED AND MAY NOT BE COPIED, REPRODUCED OR ITS CONTENTS DIVULGED WITHOUT PRIOR WRITTEN CONSENT FROM VISION AGI LIMITED.	

Rev	Date	Init	Revision

NEXT GENERATION ROOFLIGHTS
 Queens Business Park
 Wilbraham Road
 Fulbourn
 Cambridge
 CB21 5GT
 T: 01223 792 224
 E: sales@nextgenrooflights.co.uk
 info@nextgenrooflights.co.uk
 W: nextgenrooflights.co.uk



Client:

Title: Sliding Over Fixed - Rooflight Detail D			
Project: Rooflight			
Scales: 1:2 @ A3	Date: 01/07/22	Drawn: CR	Chk: CR
Drg No.: 300-SALES-101(6)		Rev: -	

Staircase Example
(for roof terrace access)

Section L-L (Scale 1 : 25)

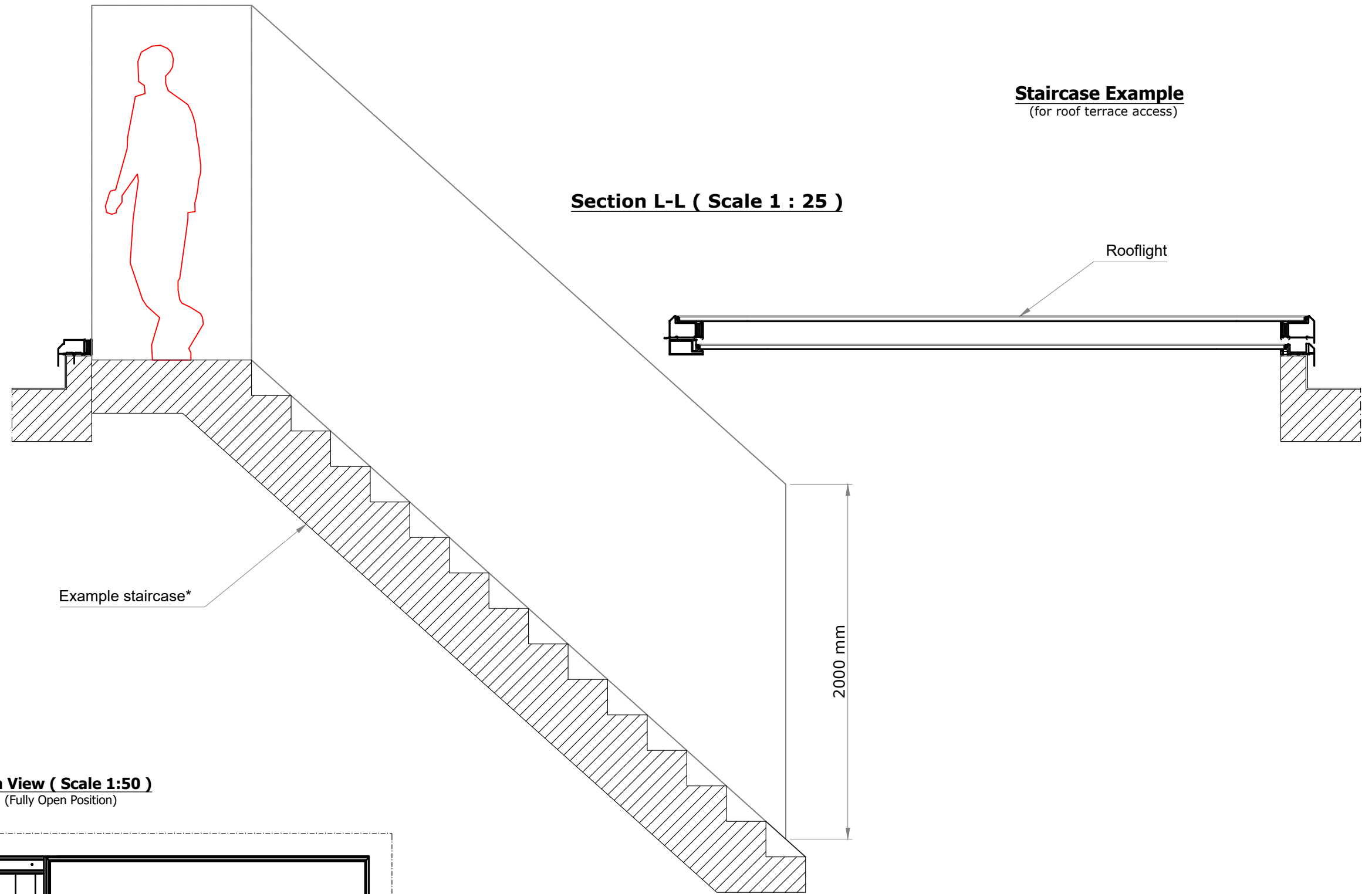

Plan View (Scale 1:50)
(Fully Open Position)

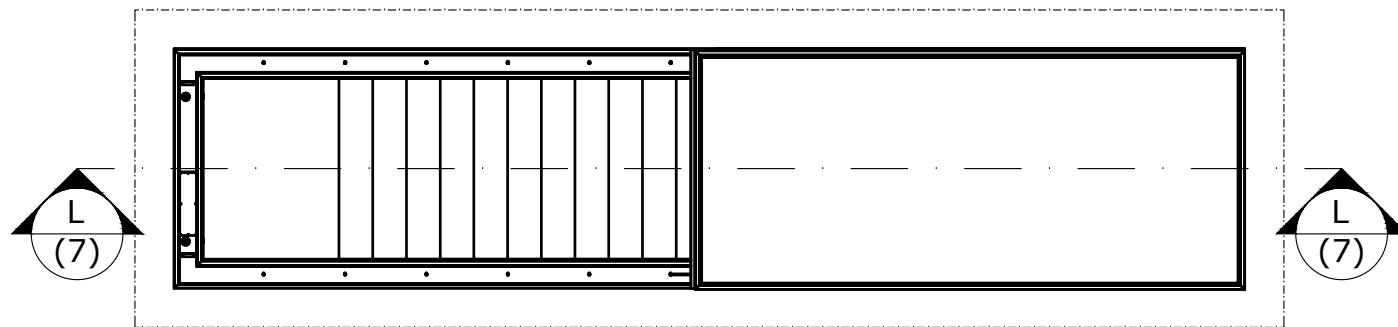

*The staircase shown is just one typical example just to show sizes that comply with Approved Document K of Building Regulations. This does not constitute a design proposal. There are many other options, we recommend you check with your local building control office when designing the staircase.



GENERAL NOTES

1. NO DIMENSIONS ARE TO BE SCALED FROM THIS DRAWING.
2. DISCREPANCIES IN SITE DIMENSIONS TO BE REPORTED TO NEXT GENERATION ROOFLIGHTS.
3. ALL DIMENSIONS IN MILLIMETERS.
4. ALL LEVELS IN METRES.
5. THIS DRAWING REMAINS THE PROPERTY OF VISION AGI LIMITED AND MAY NOT BE COPIED, REPRODUCED OR ITS CONTENTS DIVULGED WITHOUT PRIOR WRITTEN CONSENT FROM VISION AGI LIMITED.

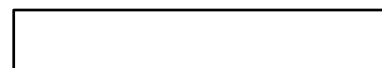

Next Generation Rooflights is a trading name of Vision AGI Limited, Company No. 08429446, Registered Office: 1 Vicarage Lane, Stratford, London, E15 4HF

Rev	Date	Init	Revision

NEXT GENERATION ROOFLIGHTS
Queens Business Park
Wilbraham Road
Fulbourn
Cambridge
CB21 5GT
T: 01223 792 224
E: sales@nextgenrooflights.co.uk
info@nextgenrooflights.co.uk
W: nextgenrooflights.co.uk



Client: _____

Title: Sliding Over Fixed - Rooflight Staircase Example			
Project: Rooflight			
Scales: 1:25 & 1:50 @ A3	Date: 01/07/22	Drawn: CR	Chk: CR
Drg No.: 300-SALES-101(7)		Rev: -	

Upstand Drawing 3°-5°

(For flat roofs)

For Detail E - See drawing:
300-SALES-101(8)

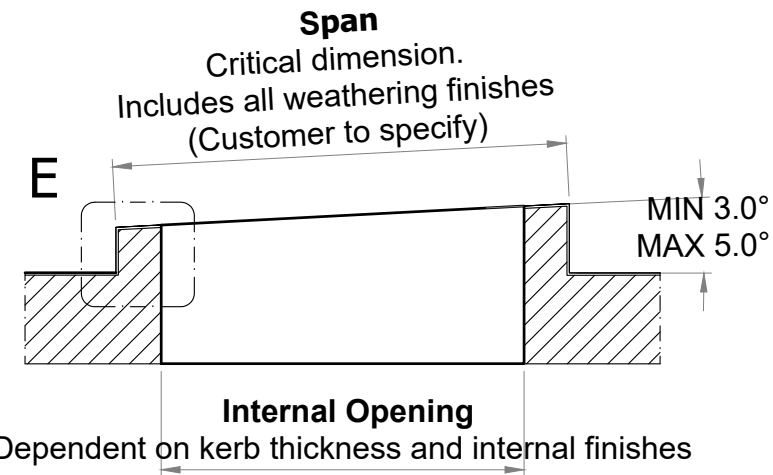

Section G-G (Scale 1 : 25)

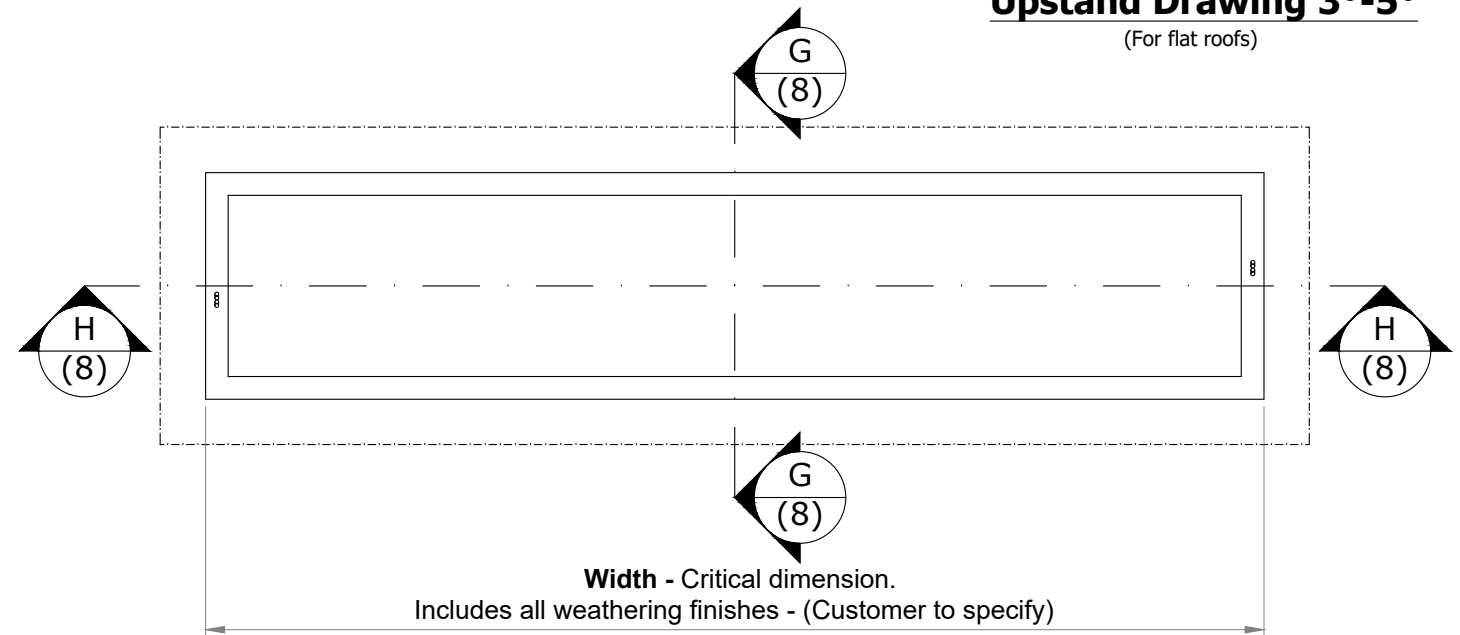

Plan View (Scale 1:50)

***Top face must be level with rail upstands**

***External weathering**
Membranes may be wrapped over the top face. Lead or other metallic weathering must not extend over the top face. (By Others)

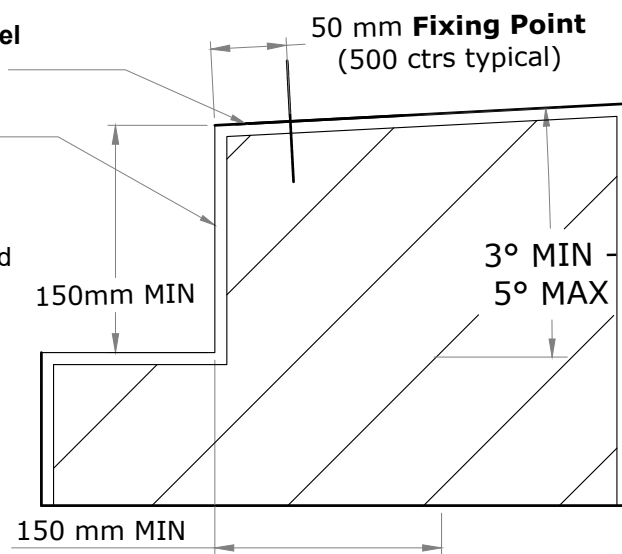

Detail E (Scale 1:5)

*Next Generation Rooflights Strongly recommends that a structural engineer is consulted when designing the structure(s) that will support the product and the surrounding roof. Nothing in this drawing constitutes a structural proposal.

Width - Critical dimension.
Includes all weathering finishes - (Customer to specify)

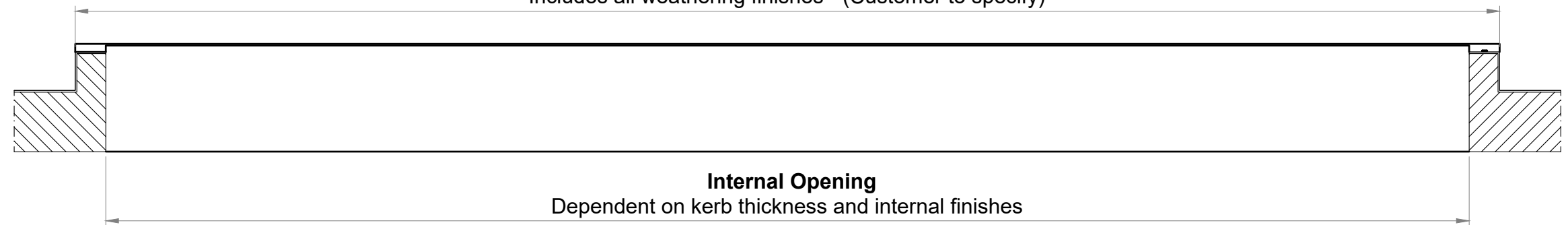

Section H-H (Scale 1 : 25)



GENERAL NOTES

1. NO DIMENSIONS ARE TO BE SCALED FROM THIS DRAWING.
2. DISCREPANCIES IN SITE DIMENSIONS TO BE REPORTED TO NEXT GENERATION ROOFLIGHTS.
3. ALL DIMENSIONS IN MILLIMETERS.
4. ALL LEVELS IN METRES.
5. THIS DRAWING REMAINS THE PROPERTY OF VISION AGI LIMITED AND MAY NOT BE COPIED, REPRODUCED OR ITS CONTENTS DIVULGED WITHOUT PRIOR WRITTEN CONSENT FROM VISION AGI LIMITED.

Next Generation Rooflights is a trading name of Vision AGI Limited, Company No. 08429446, Registered Office: 1 Vicarage Lane, Stratford, London, E15 4HF

Rev	Date	Init	Revision

NEXT GENERATION ROOFLIGHTS
Queens Business Park
Wilbraham Road
Fulbourn
Cambridge
CB21 5GT
T: 01223 792 224
E: sales@nextgenrooflights.co.uk
info@nextgenrooflights.co.uk
W: nextgenrooflights.co.uk



Client:

Title: Sliding Over Fixed - Rooflight
Upstand drawing (3°-5°)

Project: Rooflight

Scales: As indicated above	Date: 01/07/22	Drawn: CR	Chk: CR
Drg No.: 300-SALES-101(8)	Rev: -		

Upstand Drawing 5°-45°

(Parallel to pitched roof)

For Detail F - See drawing:
300-SALES-101(9)

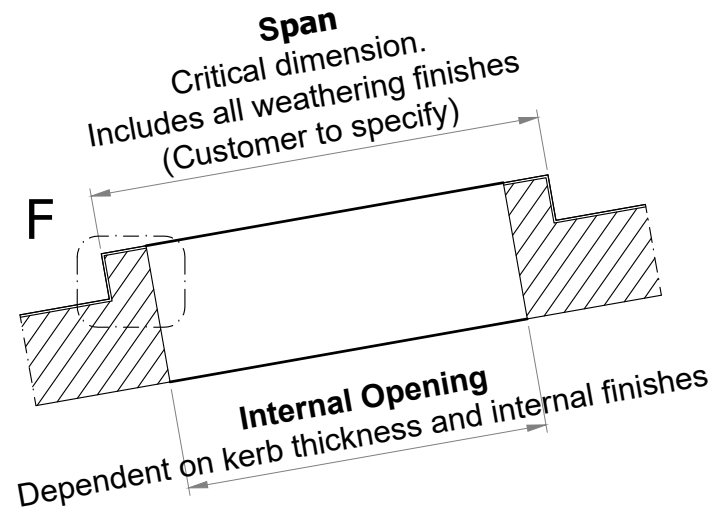

Section J-J (Scale 1 : 25)

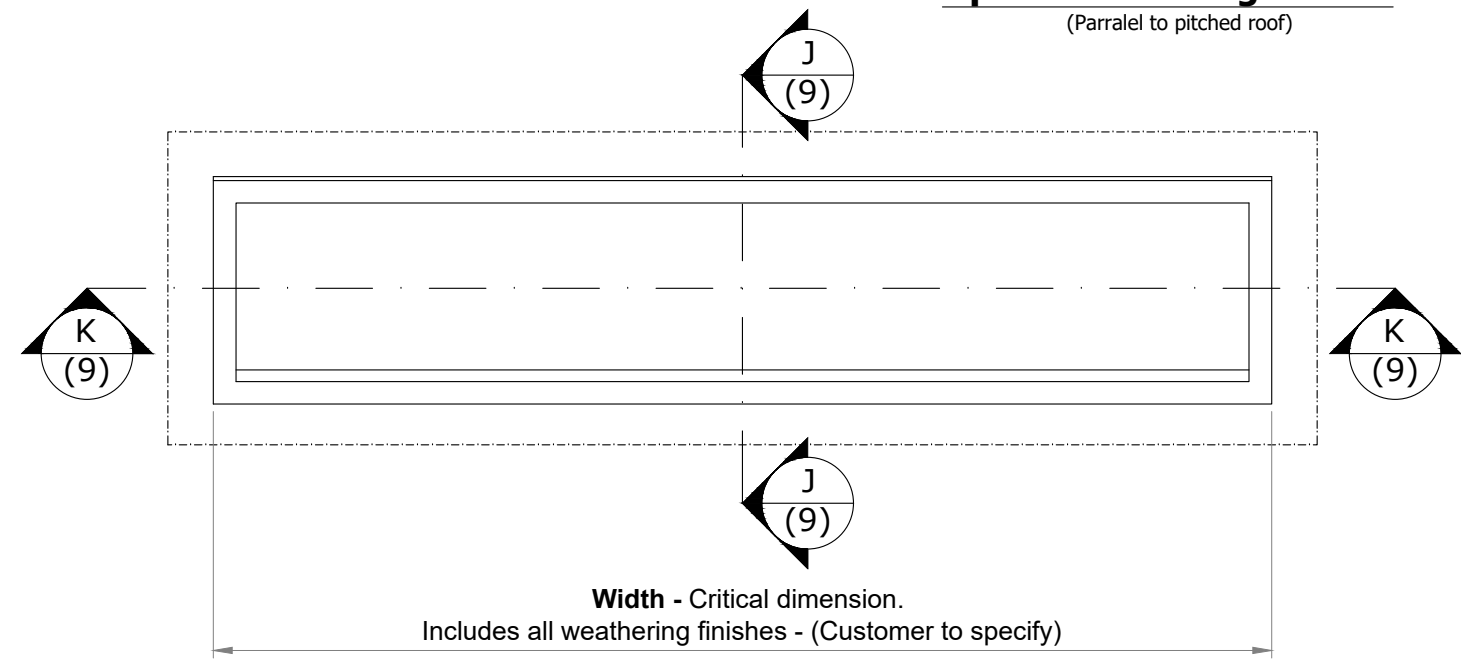

Plan View (Scale 1:50)

***Top face must be level with rail upstands**

***External weathering**
Membranes may be wrapped over the top face. Lead or other metallic weathering must not extend over the top face. (By Others)

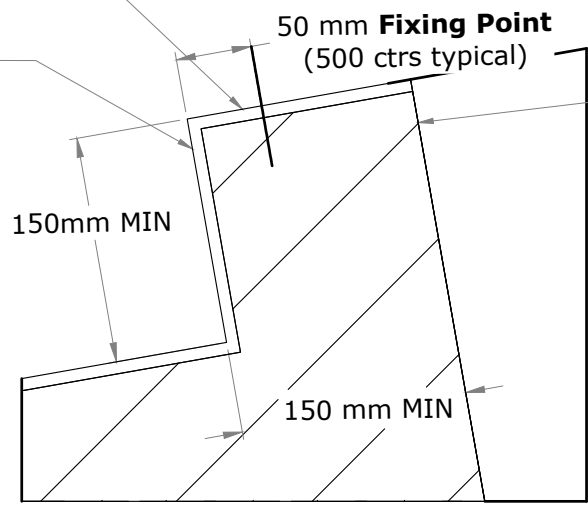

Detail F (Scale 1:5)

***Fully weathered Structural Upstand.** Must provide secure fixing point and support the rooflight. There must be no steps or undulations on the top surface that exceed ±2mm (By Others)

*Next Generation Rooflights Strongly recommends that a structural engineer is consulted when designing the structure(s) that will support the product and the surrounding roof. Nothing in this drawing constitutes a structural proposal.

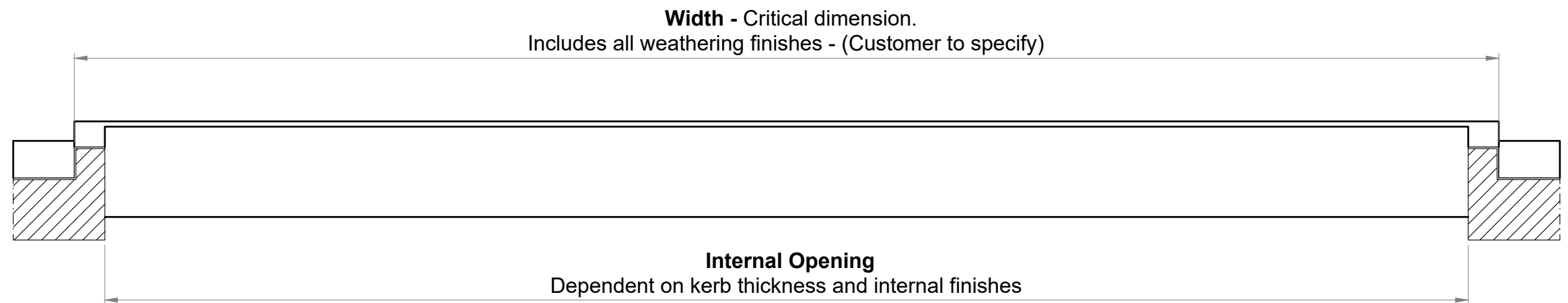

Section K-K (Scale 1 : 25)

GENERAL NOTES

- NO DIMENSIONS ARE TO BE SCALED FROM THIS DRAWING.
- DISCREPANCIES IN SITE DIMENSIONS TO BE REPORTED TO NEXT GENERATION ROOFLIGHTS.
- ALL DIMENSIONS IN MILLIMETERS.
- ALL LEVELS IN METRES.
- THIS DRAWING REMAINS THE PROPERTY OF VISION AGI LIMITED AND MAY NOT BE COPIED, REPRODUCED OR ITS CONTENTS DIVULGED WITHOUT PRIOR WRITTEN CONSENT FROM VISION AGI LIMITED.

Next Generation Rooflights is a trading name of Vision AGI Limited, Company No. 08429446, Registered Office: 1 Vicarage Lane, Stratford, London, E15 4HF

Rev	Date	Init	Revision

NEXT GENERATION ROOFLIGHTS
 Queens Business Park
 Wilbraham Road
 Fulbourn
 Cambridge
 CB21 5GT
 T: 01223 792 224
 E: sales@nextgenrooflights.co.uk
 info@nextgenrooflights.co.uk
 W: nextgenrooflights.co.uk



Client:

Title: Sliding Over Fixed - Rooflight Upstand drawing (5°-45°)			
Project: Rooflight			
Scales: As indicated above	Date: 01/07/22	Drawn: CR	Chk: CR
Drg No.: 300-SALES-101(9)		Rev: -	